



**IMM.M.M.**

**Q**

Raccordi per tubo PTFE / *Fittings for PTFE hose*

P  
Q

**IMM Hypress**  
IMM Group



**Raccordi per tubo PTFE / Fittings for PTFE hose**

Pagina / Page	2	2	3	3	5	
<b>Ghiere Ferrule</b>			<b>GAS BSP</b>			
	<b>OTP1</b> Per Tubo 'T' For 'T' hose	<b>00TC</b> Per Tubo 'TC' For 'TC' hose		<b>T051</b> BSP straight 60° cone	<b>T151</b> BSP 90° 60° cone	<b>T350</b> BSP Male
Pagina / Page	4	4	4	5	5	
<b>Metric Metrico</b>		<b>Jic</b>		<b>Male BSPT</b>		
	<b>T100</b> Metric straight 60° cone		<b>T901</b> Jic straight 37° Flare		<b>T360</b> BSPT Male Maschio BSPT	
Pagina / Page	6	6	6	7	7	
<b>Male NPT</b>		<b>Occhio Banjo</b>		<b>Ermeto Standpipe</b>		
	<b>T370</b> NPT Male Maschio NPT		<b>T140</b> Banjo Occhio		<b>T550</b> Ermeto - Standpipe DIN 3901	
Pagina / Page	7	8	8	8	9	
<b>Flange</b>				<b>Female Reusable</b>		
	<b>TPFO</b> Porta Flangia	<b>TPFR</b> Porta Flangia rivestita PTFE	<b>TFPG</b> Flangia Piana Girevole		<b>TR51</b> BSP Female Reusable	

Dimensions and general characteristics may be changed at any time without prior notice.

Data contained herein are for information purpose only, and it does not enlarge, amend or imply any warranty other than provided by us with the product  
Any use of the product not in conformance with our instructions may be dangerous.

## 0TP1 Boccola a Pressare

Swaged Ferrule

per tubo / for hose:

TP1 - TM1 - T2 - THP

**Materiale (std):** Ottone - UNI 5705-65

**Material (std):** Brass - UNI 5705-65

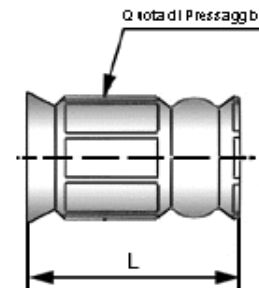

part number	hose I.D.		Dimensions	
	mm	inch	L	Ø Pressatura**
0TP1-03	5	3/16"	16,5	10,8
0TP1-04	6,5	1/4"	18	12,9
0TP1-05	8	5/16"	20	14,4
0TP1-06	9,5	3/8"	20	15,7
0TP1-07	10,5	13/32"	20	16,7
0TP1-08	13	1/2"	23,5	19,0
0TP1-10	16	5/8"	22	22,6
0TP1-12	19	3/4"	29	26,3
0TP1-14	22	7/8"	28	29,3
0TP1-16	25	1"	29	32,6
0TP1-18	28,5	1.1/8"	30,5	36,9
0TP1-20	32	1.1/4"	38	43,0
0TP1-24	38	1.1/2"	38	49,2
0TP1-50	50	2"	53	65,5

\*\* - Tolleranza:  $\pm 0,5\%$  del Ø Pressatura

## 00TC Boccola a Pressare

Swaged Ferrule

per tubo / for hose:

TC

**Materiale (std):** Ottone - UNI 5705-65

**Material (std):** Brass - UNI 5705-65

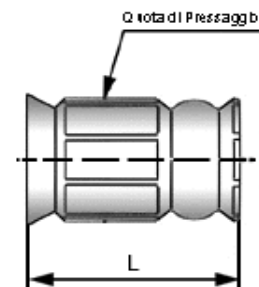

part number	hose I.D.		Dimensions	
	mm	inch	L	Ø Pressatura**
00TC-04	6,9	1/4"	26	10,8
00TC-06	9,5	3/8"	20	12,9
00TC-08	13	1/2"	21	14,4
00TC-10	16	5/8"	22	15,7
00TC-12	19	3/4"	28	16,7
00TC-16	25	1"	29	19,0
00TC-20	32	1.1/4"	38	22,6
00TC-24	38	1.1/2"	38	26,3
00TC-50	51	2"	53	29,3
*** 00TC-51	51	2"	53	32,6

\*\* - Tolleranza:  $\pm 0,5\%$  del Ø Pressatura

\*\*\* - Usare solo codoli rivestiti in P.T.F.E.



## T051 Femmina BSP cono 60°

BSP Female 60° cone

**Materiale (std):** inserto: Ottone - UNI 5705-65 / Dado: acciaio - UNI 5105

**Material (std):** insert: Brass - UNI 5705-65 / Nut: steel - UNI 5105

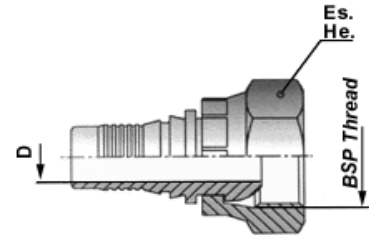

part number	hose I.D.		Dimensions			
	mm	inch	Thread	D	He	
T051-03-02	5	3/16"	1/8"	3,5	14	
T051-04-04	6,5	1/4"	1/4"	4,5	19	
T051-05-06	8	5/16"	3/8"	5,5	22	
T051-06-06	9,5	3/8"	3/8"	7,0	22	
T051-06-08	9,5	3/8"	1/2"	7,0	27	
T051-07-08	10,5	13/32"	1/2"	8,0	27	
T051-08-08	13	1/2"	1/2"	10,0	27	
T051-10-12	16	5/8"	3/4"	12,5	32	
T051-12-12	19	3/4"	3/4"	15,0	32	
T051-12-16	19	3/4"	1"	15,0	38	
T051-14-16	22	7/8"	1"	18,0	38	
T051-16-16	25	1"	1"	20,0	38	
T051-18-20	28,5	1.1/8"	1.1/4"	24,0	50	
T051-20-20	32	1.1/4"	1.1/4"	27,0	50	
T051-24-24	38	1.1/2"	1.1/2"	33,0	55	
T051-32-32	50	2"	2"	44,0	65	

## T151 Curva 90° BSP cono 60°

BSP 90° Swept elbow 60° cone

**Materiale (std):** inserto: Ottone - UNI 5705-65 / Dado: acciaio - UNI 5105

**Material (std):** insert: Brass - UNI 5705-65 / Nut: steel - UNI 5105

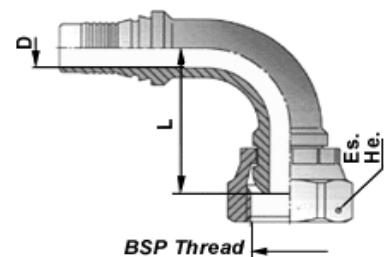

part number	hose I.D.		Dimensions			
	mm	inch	Thread	D	He	
T151-03-02	5	3/16"	1/8"	3,5	14	
T151-04-04	6,5	1/4"	1/4"	4,5	19	
T151-05-06	8	5/16"	3/8"	5,5	22	
T151-06-06	9,5	3/8"	3/8"	7,0	22	
T151-08-08	13	1/2"	1/2"	10,0	27	
T151-12-12	19	3/4"	3/4"	15,0	32	
T151-16-16	25	1"	1"	19,0	38	

## T100 **Femmina Metrica Cono 60°**

*Metric Female 60° cone*

**Materiale (std):** inserto: Ottone - UNI 5705-65 / Dado: acciaio - UNI 5105

**Material (std):** insert: Brass - UNI 5705-65 / Nut: steel - UNI 5105

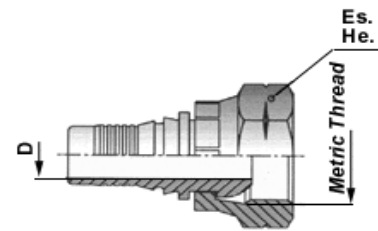

part number	hose I.D.		Dimensions			
	mm	inch	Thread	D	He	
T100-03-10	5	3/16"	10 x 1	3,5	14	
T100-04-12	5	1/4"	12 x 1	3,5	19	
T100-05-14	6,5	1/4"	14 x 1,5	4,5	19	
T100-06-16	8	5/16"	16 x 1,5	5,5	22	
T100-06-20	13	1/2"	20 x 1,5	10,0	24	
T100-07-22	13	1/2"	22 x 1,5	10,0	27	

## T901 **Femmina JIC svas. 74°**

*JIC Female 74° cone*

**Materiale (std):** inserto: Ottone - UNI 5705-65 / Dado: acciaio - UNI 5105

**Material (std):** insert: Brass - UNI 5705-65 / Nut: steel - UNI 5105

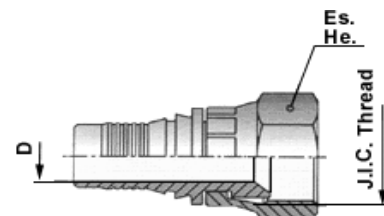

part number	hose I.D.		Dimensions			
	mm	inch	Thread	D	He	
T901-03-04	5	3/16"	7/16" - 20	3,5	15	
T901-04-05	6,5	1/4"	1/2" - 20	4,5	17	
T901-05-06	8	5/16"	9/16" - 18	5,5	19	
T901-05-05	8	5/16"	1/2" - 20	5,5	19	
T901-06-06	9,5	3/8"	9/16" - 18	7,0	19	
T901-07-08	10,5	13/32"	3/4" - 16	8,0	24	
T901-07-10	10,5	13/32"	7/8" - 14	10,0	27	
T901-08-08	13	1/2"	3/4" - 16	10,0	24	
T901-10-12	16	5/8"	1 1/16" - 12	12,5	32	

## T350 Maschio BSP svas. 60°

*BSP Male Parallel 60° cone*

**Materiale (std):** Ottone - UNI 5705-65

**Material (std):** Brass - UNI 5705-65

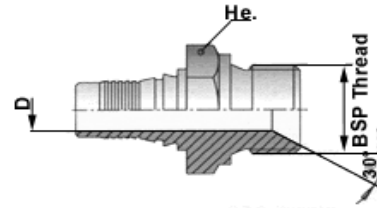

part number	hose I.D.		Dimensions			
	mm	inch	Thread	D	He	
T350-03-02	5	3/16"	1/8"	3,5	12	
T350-04-04	6,5	1/4"	1/4"	4,5	19	
T350-05-06	8	5/16"	3/8"	5,5	17	
T350-06-06	9,5	3/8"	3/8"	7,0	22	
T350-06-08	9,5	3/8"	1/2"	7,0	27	
T350-07-08	10,5	13/32"	1/2"	8,0	27	
T350-08-08	13	1/2"	1/2"	10,0	27	
T350-10-12	16	5/8"	3/4"	12,5	27	
T350-12-12	19	3/4"	3/4"	15,0	32	
T350-14-16	22	7/8"	1"	18,0	36	
T350-16-16	25	1"	1"	20,0	41	
T350-18-20	28,5	1 1/8"	1 1/4"	24,0	46	

## T360 Maschio BSPT svas. 60°

*BSP Taper Male 60° cone*

**Materiale (std):** Ottone - UNI 5705-65

**Material (std):** Brass - UNI 5705-65

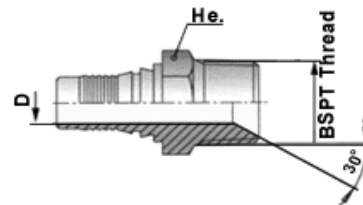

part number	hose I.D.		Dimensions			
	mm	inch	Thread	D	He	
T360-03-02	5	3/16"	1/8"	3,5	12	
T360-04-04	6,5	1/4"	1/4"	4,5	15	
T360-05-06	8	5/16"	3/8"	5,5	18	
T360-06-06	9,5	3/8"	3/8"	7,0	18	
T360-08-08	13	1/2"	1/2"	10,0	22	
T360-16-16	25	1"	1"	20,0	36	
T360-18-20	29	1 1/8"	1 1/4"	24,0	46	
T360-20-20	32	1 1/4"	1 1/4"	27,0	46	
T360-24-24	38	1 1/2"	1 1/2"	32,0	50	
T360-32-32	51	2"	2"	44,5	65	

## T370 Maschio NPTF svas. 60°

NPTF Male 60° cone

**Materiale (std):** Ottone - UNI 5705-65

**Material (std):** Brass - UNI 5705-65

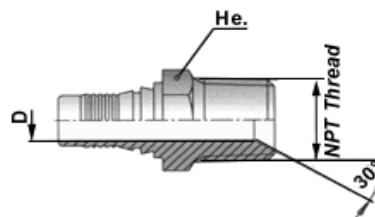

part number	hose I.D.		Dimensions			
	mm	inch	Thread	D	He	
T370-03-02	5	3/16"	1/8"	3,5	12	
T370-04-04	6,5	1/4"	1/4"	4,5	15	
T370-05-06	8	5/16"	3/8"	5,5	18	
T370-06-06	9,5	3/8"	3/8"	7,0	18	
T370-07-08	10,5	13/32"	1/2"	8,0	22	
T370-08-08	13	1/2"	1/2"	10,0	22	
T370-10-12	16	5/8"	3/4"	12,5	27	
T370-12-12	19	3/4"	3/4"	16,0	27	
T370-16-16	25	1"	1"	20,0	36	
T370-18-20	29	1 1/8"	1 1/4"	24,0	46	
T370-20-20	32	1 1/4"	1 1/4"	27,0	46	
T370-24-24	38	1 1/2"	1 1/2"	32,0	50	
T370-32-32	51	2"	2"	44,5	65	

## T140 Occhio

Banjo

**Materiale (std):** Ottone - UNI 5705-65

**Material (std):** Brass - UNI 5705-65

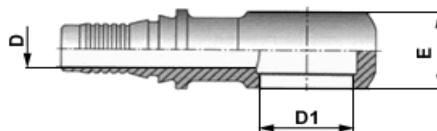

part number	hose I.D.		Dimensions			
	mm	inch	D1	D	E	
T140-03-10	5	3/16"	10,1	3,5	10	
T140-04-10	6,5	1/4"	10,1	4,5	10	
T140-04-12	6,5	1/4"	12,1	4,5	12	
T140-05-06	8	5/16"	16,7(3/8")	5,5	12	
T140-06-12	9,5	3/8"	12,1	7,0	15	
T140-06-04	9,5	3/8"	13,2(1/4")	7,0	15	
T140-06-14	9,5	3/8"	14,2	7,0	15	
T140-06-16	9,5	3/8"	16,2	7,0	15	
T140-08-08	13	1/2"	21(1/2")	10,0	22	
T140-12-12	19	3/4"	27	15,0	30	



## T550 Femmina Metrica Tubolare Diritta

*Metric Standpipe*

**Materiale (std):** Ottone - UNI 5705-65

**Material (std):** Brass - UNI 5705-65

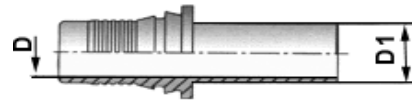

part number	hose I.D.		Dimensions		
	mm	inch	D1	D	
T550-03-06	5	3/16"	6	3,5	
T550-03-08	5	3/16"	8	3,5	
T550-04-06	6,5	1/4"	6	4,5	
T550-04-08	6,5	1/4"	8	4,5	
T550-04-10	6,5	1/4"	10	4,5	
T550-04-12	6,5	1/4"	12	4,5	
T550-05-10	8	5/16"	10	5,5	
T550-05-12	8	5/16"	12	5,5	
T550-06-12	9,5	3/8"	12	7,0	
T550-06-14	9,5	3/8"	14	7,0	
T550-08-12	13	1/2"	12	10,0	
T550-08-15	13	1/2"	15	10,0	
T550-08-16	13	1/2"	16	10,0	
T550-10-18	16	5/8"	18	12,5	
T550-10-20	16	5/8"	20	12,5	
T550-12-22	19	3/4"	22	15,0	
T550-12-25	19	3/4"	25	15,0	
T550-16-28	25	1"	28	20,0	
T550-16-30	25	1"	30	20,0	

## TFLO Porta flangia

*Flanged joint*

**Materiale (std):** Ottone - UNI 5705-65

**Material (std):** Brass - UNI 5705-65

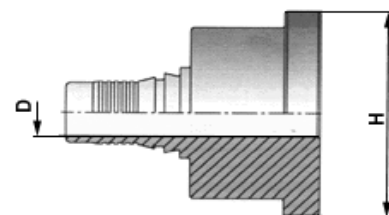

part number	hose I.D.		Dimensions		
	mm	inch	H	D	
TFLO-08-43	13	1/2"	43	10	
TFLO-12-45	19	3/4"	45	15	
TFLO-16-45	25	1"	45	20	
TFLO-20-60	32	1 1/4"	60	27	
TFLO-24-80	38	1 1/2"	80	32	
TFLO-32-80	50	2"	80	45	

## TPFR Porta flangia rivestito in P.T.F.E. puro

*P.T.F.E. Lined flanged joint*

**Materiale (std):** Ottone - UNI 5705-65

**Material (std):** Brass - UNI 5705-65

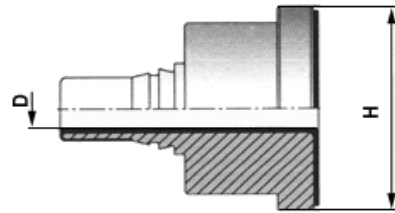

part number	hose I.D.		Dimensions		
	mm	inch	H	D	
TPFR-08-43	13	1/2"	43	8	
TPFR-12-45	19	3/4"	45	13	
TPFR-16-45	25	1"	45	18	
TPFR-20-60	32	1 1/4"	60	24	
TPFR-24-80	38	1 1/2"	80	29	
TPFR-32-80	50	2"	80	39	

## TFFPG Flangia piana girevole

*Swivel flange*

*According to: UNI 2278 PN 16*

**Materiale (std):** Ottone - UNI 5705-65

**Material (std):** Brass - UNI 5705-65

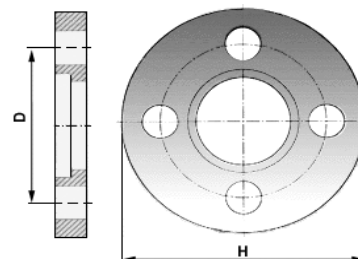

part number	DN		Dimensions			
	mm	inch	Ø ID Hole	D	H	
TFFPG-08	15	1/2"	14	65	95	
TFFPG-12	20	3/4"	14	75	105	
TFFPG-16	25	1"	14	85	115	
TFFPG-20	32	1 1/4"	18	100	140	
TFFPG-24	40	1 1/2"	18	110	150	
TFFPG-32	50	2"	18	125	165	
TFFPG-40	65	2 1/2"	18	145	185	
TFFPG-48	80	3"	18	160	200	
TFFPG-64	100	4"	18	180	220	

## TR51 **Femmina diritta recuperabile BSP**

*BSP straight female Reusable fitting*

According to: **ISO 8434-2**

**Materiale (std):** acciaio al carbonio

**Material (std):** carbon steel

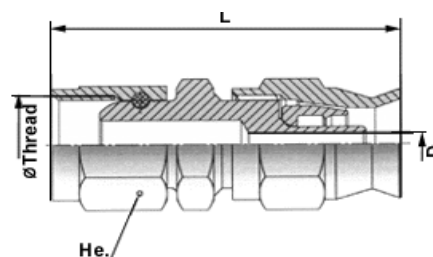

part number	hose I.D.		Dimensions			
	mm	inch	Thread	D	L	He
TR51-03-04	3/16"	5	1/4"	4,0	40,0	17
TR51-04-04	1/4"	6,5	1/4"	5,5	45,5	17
TR51-05-06	5/16"	8	3/8"	7,0	47,5	22
TR51-07-08	13/32"	10,5	1/2"	9,5	53,5	27
TR51-10-12	5/8"	16	3/4"	15,0	61,0	36
TR51-14-16	7/8"	22	1"	21,0	65,0	41

